

THRU TO CENTER SM1(1.035in-40) SERIES
INTERNAL THREAD ACCEPTS 25.4mm[1.0in]
MAXIMUM 6.1mm[0.24in] THICK OPTICS
2 GYKH25A RETAINING RING INCLUDED
23mm [0.91in] CLEAR APERTURE

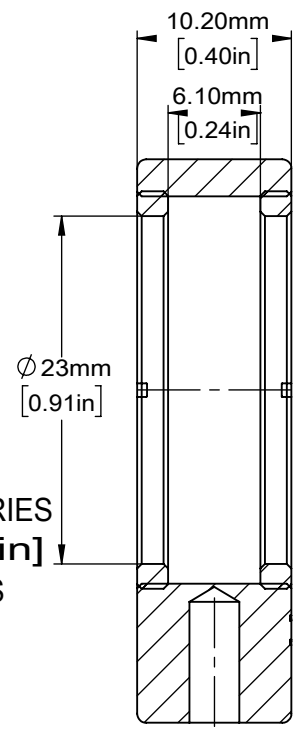

A-A

DRAWING PROJECTION

OMTOOLS

REV	A0	F2H25B	
DRAWN	TODD		
DATE	2020/5/13	WEIGHT	SCALE
FOR INFORMATION ONLY NOT FOR MANUFACTURING PURPOSES		0.01kg	2:1